

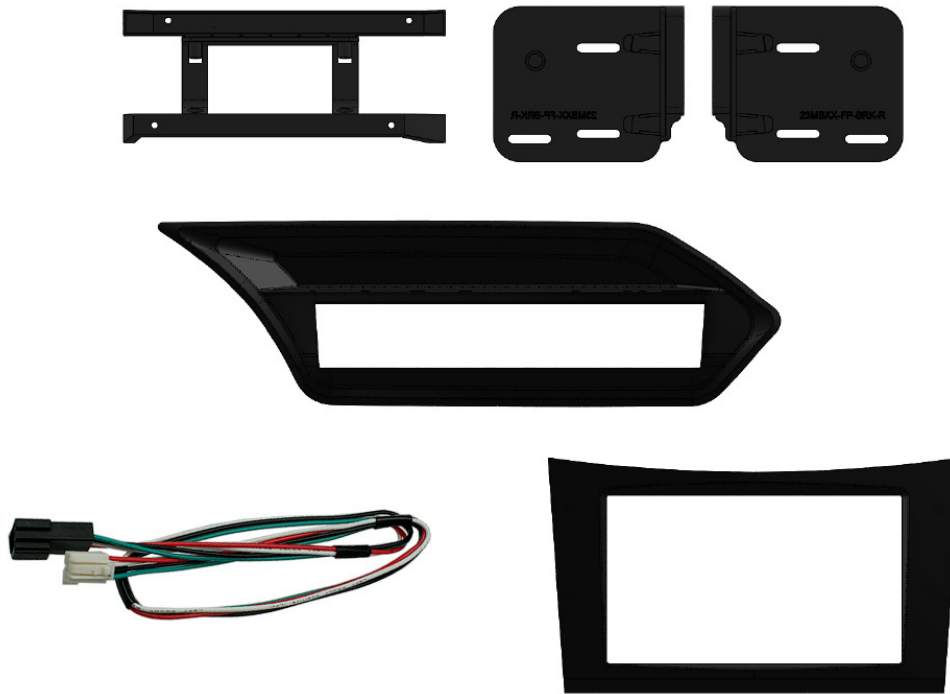

CT23MB26L

Double DIN Fitting Kit for Mercedes Benz Vehicles



- | | | | |
|------|---------------------------|-----|--------------------------|
| i. | Button Relocation Panel | vi. | Screws |
| ii. | Relocation Panel Bracket | | - 1/4" Self Tapping (x2) |
| iii. | Button Retention Cable | | - M5 8mm (x4) |
| iv. | Double DIN Fascia Panel | | - 3.8" Self Tapping (x6) |
| v. | Left/Right Radio Brackets | | |

APPLICATION

Note: Application data is subject to change at any time

Mercedes Benz E Class (W212) 2009 - 2012

Compatible with Left Hand Drive Vehicles Only

RECOMMENDED TOOLS

- Panel Removal Tool
- Screwdriver

FEATURES

- Allows for the installation of a double DIN aftermarket stereo
- Includes panel for relocation of OEM buttons
- Includes mounting brackets and fitting accessories
- Finished in black to match vehicle dashboard

DISCLAIMER

The information provided in this document is subject to change without notice due to manufacturer changes and/or improvements to the product/s. This instruction manual is based on documented data and research. The manufacturer of this product cannot be held responsible for any changes made to the vehicle by the manufacturer or damages that may occur through the installation of this product in accordance with the steps outlined herein.

PRIOR TO INSTALLATION

Read the manual prior to installation. Technical knowledge is necessary for installation. The place of installation must be free of moisture and away from heat sources. Please ensure that the correct tools are using during the installation to avoid damage to the vehicle or product. Connects2 can not be held responsible for the installation of this product.

Included in this kit:

- 1x Button Relocation Panel
- 1x Relocation Panel Bracket
- 1x Button Retention Cable
- 1x Double DIN Fascia Panel
- 1x Left Radio Bracket
- 1x Right Radio Bracket
- 2x 1/4" Self Tapping Screw
- 4x M5 8mm Screw
- 6x 3.8" Self Tapping Screw

INSTALLATION GUIDE

DASH DISASSEMBLY

1. Use a panel removal tool to remove the air vent panel (Fig. A). Lever the clip out inside the vents as shown (Fig. B).

2. Unplug the blue connector to the air vent controls (Fig. C).

3. Partially unscrew the two (2) screws on top of the head unit. Unscrew each screw half way and then push the screw down. This will unlock the OEM head unit bracket assembly (Fig. D).

4. Remove the head unit and unplug all connections, including the connector attached to the fascia panel (Fig. E).

5. Remove the OEM fascia panel (Fig. F).

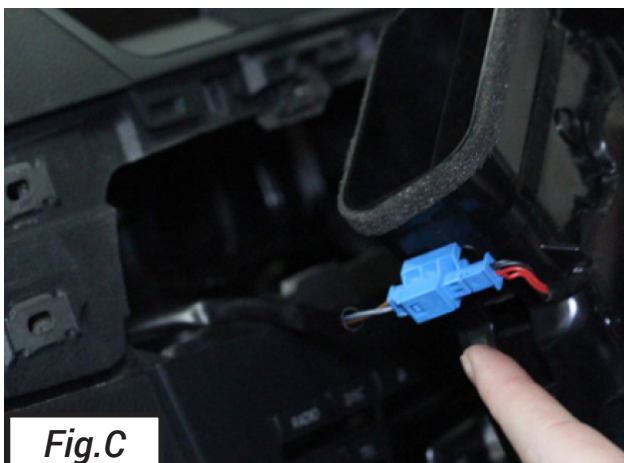
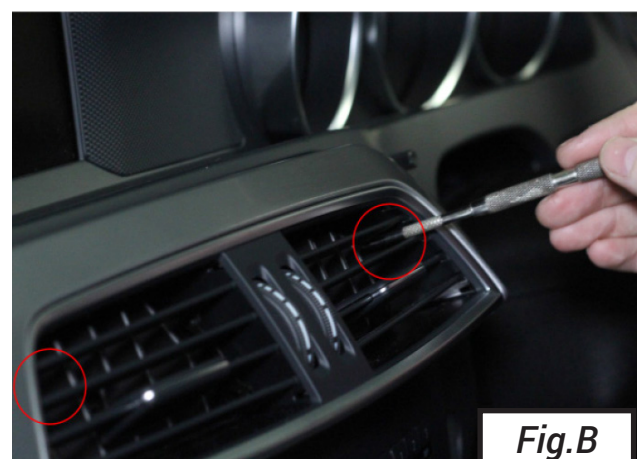

INSTALLATION GUIDE



Fig.E



Fig.F

KIT ASSEMBLY

6. Connect the black connector of the Button Relocation Lead (Fig. G) to the white OEM connector that was unplugged from the fascia panel in Step 4. Feed the cable up through the fash so that the white connector can plug into the button panel.

7. Mount the supplied radio brackets to the right and left sides of the aftermarket head unit (Fig. H).

8. Insert the head unit and wiring assembly into the dashboard. The head unit can be guided into place via the rails as a reverse of Step 3.

Test the head unit for correct operation and move on to button relocation panel assembly.

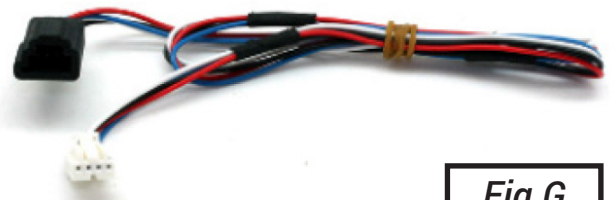

Fig.G

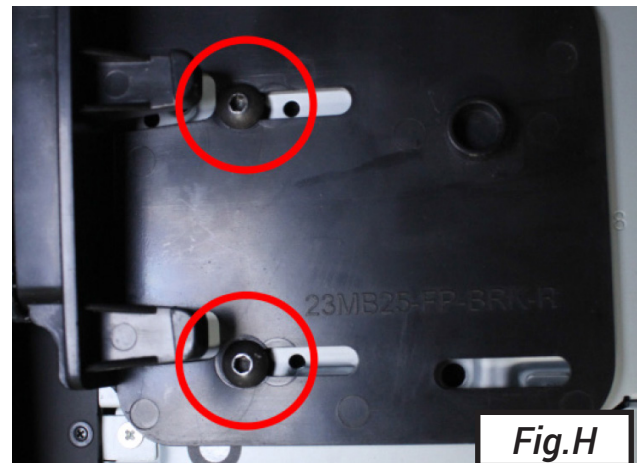
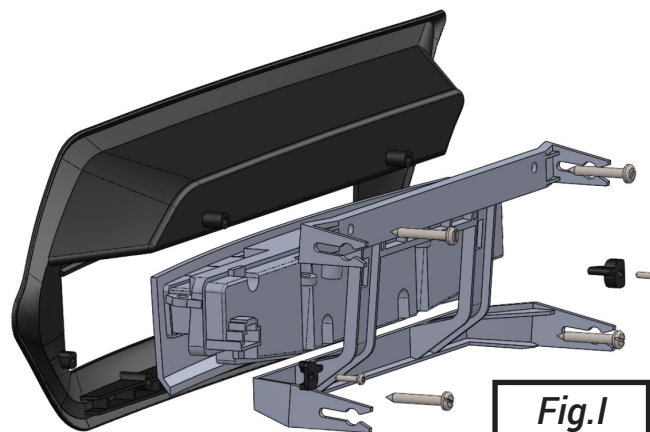

Fig.H

INSTALLATION GUIDE

BUTTON RELOCATION PANEL ASSEMBLY



9. Assemble the button relocation panel. Insert the buttons into the panel and insert the assembly below the top lip and click into place. Screw the bracket to the panel using the four holes on the back (Fig. I).

10. Screw the small plastic brackets (circled, Fig. J) into place. The bracket with two dots should be fitted to the side closest to the steering wheel.

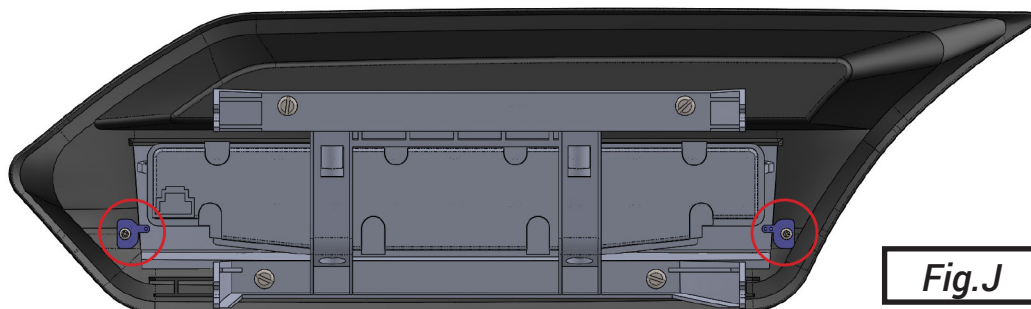

11. Screw two screws into the bottom of the bracket (Fig. K).

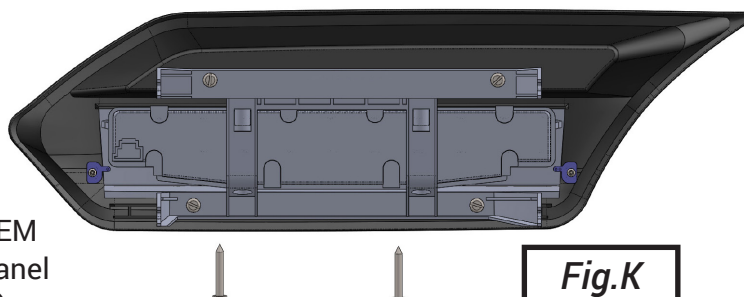

12. Connect the panel to the vehicle using the OEM connector. Once working, insert the relocation panel into the dash to complete the installation (Fig. L).

